

DOMESTIC GREASE TRAP INSTALLATION AND MAINTENANCE MANUAL

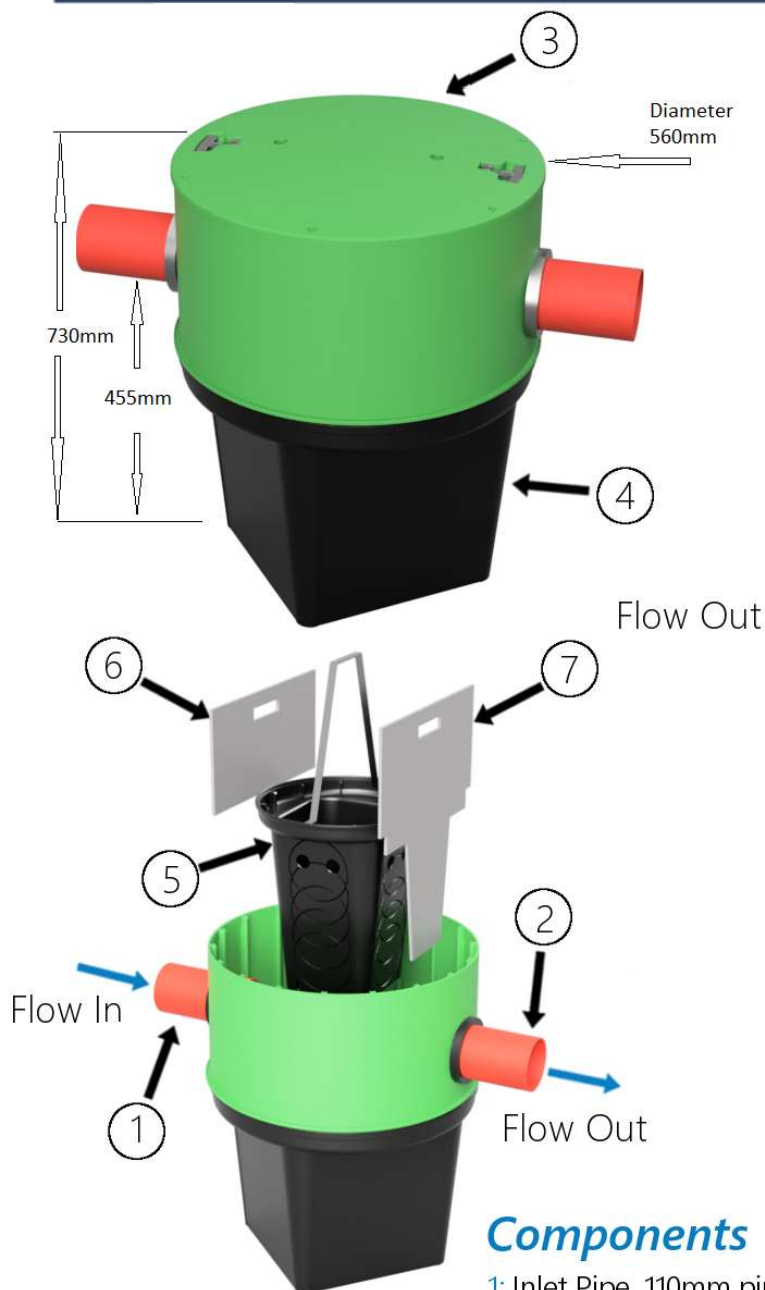

Components

- 1: Inlet Pipe, 110mm pipe
- 2: Outlet Pipe, 110mm pipe
- 3: Lid (Pedestrian)
- 4: Main Housing
- 5: Solids Sump
- 6: Inlet Baffle
- 7: Outlet Baffle

Installation for pedestrian areas only

- The grease trap must be located on the grey water pipe line only after a gully trap to prevent the escape of harmful gaseous fumes from the wastewater pipe network into the house or otherwise. The grease trap must never be installed on a sewage waste pipe line.
- Excavate a hole allowing sufficient room to install the grease trap and backfill with appropriate materials to provide a base of good standing to position the grease trap and prevent movement post installation.
- Establish the location of the greywater waste pipe and allow or cut (for an existing waste pipe installation) sufficient length to fit the grease trap from its inlet pipe to outlet pipe. Repair collars or joiners will be required depending on whether it is a new waste pipe or existing waste pipe from the house.
- Fit the grease trap into place. Remove the lid to secure the inlet and outlet pipes by hand. Then connect to the new or existing grey water pipeline.
- Fill the solids sump with clean water, then the remainder of the grease trap, refit the lid and secure with screws.
- Backfill the excavation around the grease trap with appropriate materials to prevent any movement post installation. The material selection is subject to the specific soil conditions on site.